

Operator/button modularity

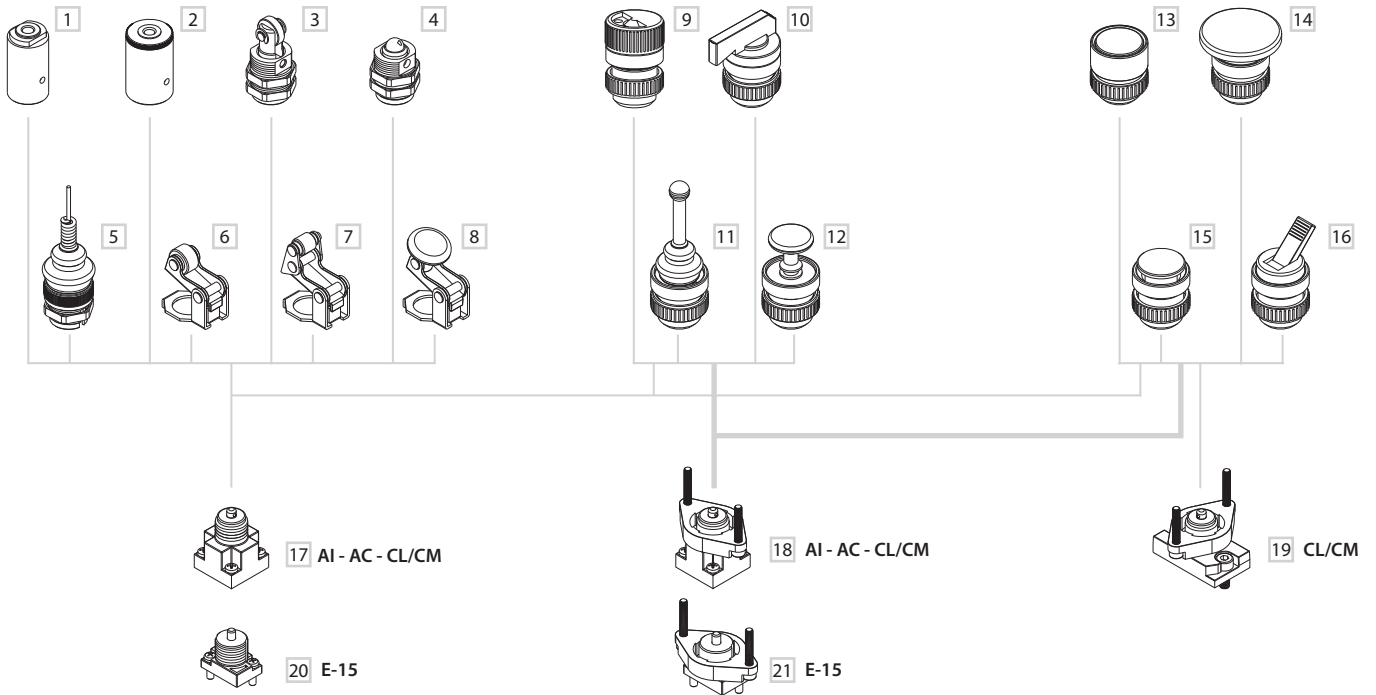

**PNEUMATIC / MECHANICAL OPERATORS**

- 1 Pneumatic operator
- 2 Amplified pneumatic operator
- 3 Roller operator 1 position
- 4 Ball-push operator 1 position
- 5 Omni-directional antenna 1 position
- 6 Roller lever operator 1 position
- 7 Articulated roller lever operator 1 position
- 8 Key operator 1 position

**MANUAL OPERATORS**

- 9 Rotating selector
- 10 Rotating lever selector
- 11 Omni-directional operator
- 12 Push-pull operator
- 13 Recessed button
- 14 Head button
- 15 Button
- 16 Lever

**VERRIDE**

- 17 Threaded indirect operation
- 18 Indirect panel operation
- 19 Direct panel operation
- 20 Ball-push direct operation
- 21 Ball-push direct panel operation

**Recessed button**

**Head button**

<ul style="list-style-type: none"> <li>■ 1 Position</li> <li>AI-3511 black ■</li> <li>AI-3512 red ■</li> <li>AI-3513 green ■</li> <li>■ For panel mounting 1 Position</li> <li>AI-3511Q black ■</li> <li>AI-3512Q red ■</li> <li>AI-3513Q green ■</li> </ul>	<ul style="list-style-type: none"> <li>■ 1 Position</li> <li>AI-3514 red ■</li> <li>AI-3516 black ■</li> <li>■ 2 Positions</li> <li>AI-3514D red ■</li> <li>AI-3516D black ■</li> <li>■ For panel mounting 1 Position</li> <li>AI-3514Q red ■</li> <li>AI-3516Q black ■</li> <li>■ For panel mounting 2 Positions</li> <li>AI-3514QD red ■</li> <li>AI-3516QD black ■</li> </ul>
--	--

**Button**

**Lever**

<ul style="list-style-type: none"> <li>■ 1 Position</li> <li>AI-3515 green ■</li> <li>AI-3517 red ■</li> <li>AI-3519 black ■</li> <li>■ For panel mounting 1 Position</li> <li>AI-3515Q green ■</li> <li>AI-3517Q red ■</li> <li>AI-3519Q black ■</li> </ul>	<ul style="list-style-type: none"> <li>■ 2 Positions</li> <li>AI-3524 black ■</li> <li>■ For panel mounting 2 Positions</li> <li>AI-3524Q black ■</li> </ul>
--	--

Rotating selector for accident prevention



■ With light 1 position

AI-3521 black ■

■ For panel mounting with light 1 position

AI-3521Q black ■

■ With light 2 positions

AI-3520 black ■

■ For panel mounting with light 2 positions

AI-3520Q black ■

Rotating lever selector



■ With light 1 position

AI-3523 black ■

■ For panel mounting with light 1 position

AI-3523Q black ■

■ With light 2 positions

AI-3522 black ■

■ For panel mounting with light 2 positions

AI-3522Q black ■

Omni-directional lever



■ With centre return 1 position

AI-3525 black ■

■ For panel mounting with centre return 1 position

AI-3525Q black ■

Push-pull operator



■ 2 positions

AI-3526 black ■

■ For panel mounting 2 positions

AI-3526Q black ■

AI-3529



reducer for Ø 30,5 to Ø 22,5, to be used with AI-35..Q limit switches

Pneumatic and mechanical operators

■ Pneumatic operator



AI-3550

■ Roller operator with dust protection



AI-3560

■ Omni-directional antenna 1 position with centre return



AI-3563

■ Roller lever 1 position



AI-3570

■ Articulated one-way roller lever 1 position



AI-3571

■ Amplified pneumatic operator



AI-3551

■ Ball operator with dust protection



AI-3562

■ Push button 1 position



AI-3572