

UCBP25

UNICLAMP Miniclamp

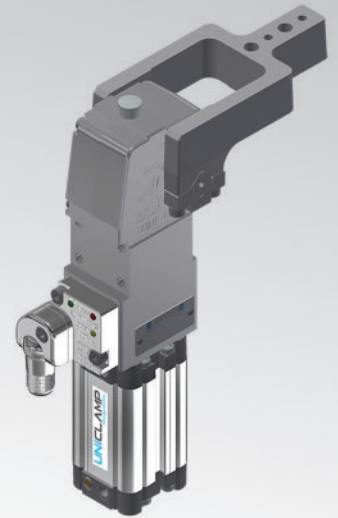

U	C	B	P	2	5	O	B	A	K	0
1	2	3	4	5	6	7	8	9		

1 Series	2 Standard	3 Version	4 Size
----------	------------	-----------	--------

UC = UNICLAMP Miniclamp
 fully adjustable opening angle:
0° to 105° Max
 The opening angle range may vary
 according to the arm position and style

B = European standard

P = Pneumatic

25 = Ø 25 mm

5 Arm position	6 Arm style	7 Arm type
----------------	-------------	------------

V = 90° O = 180° N = No arm

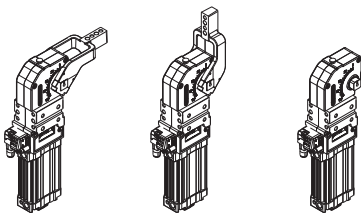

B = Central, 0 mm Offset
C = Central, 10 mm Offset
N = No arm

A = Aluminum
N = No arm

8 Sensor	9 Product revision
----------	--------------------

N = No sensor (with protection plate)
K = Electronic sensor PNP (optical) (DF-K)
D = Pneumatic sensor
J = Electronic sensor NPN (optical) (DF-J)
Y = Electronic sensor PNP (optical) (DF-Y) white led

Assigned by UNIVER

UCBP25NNNK0

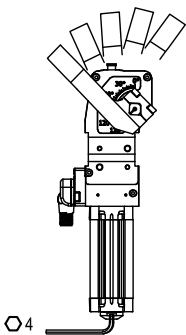
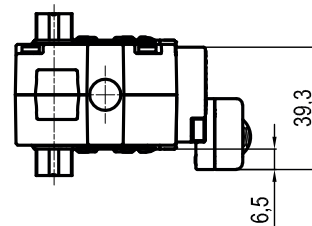
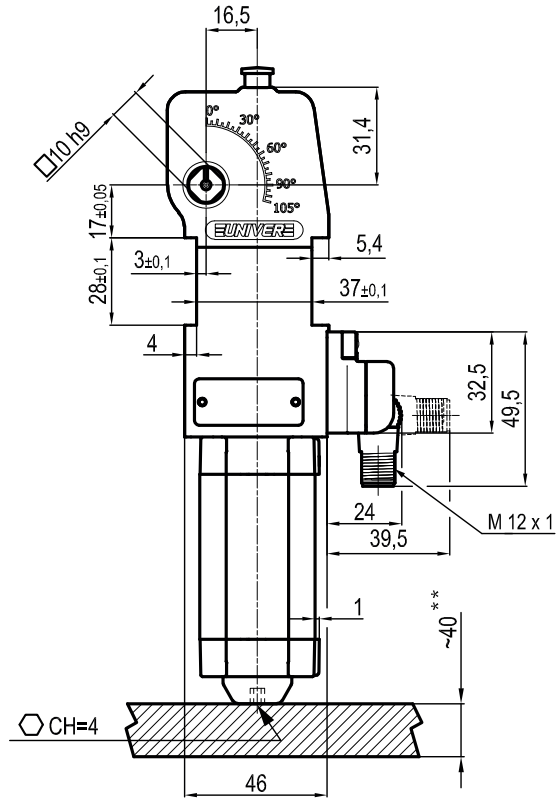
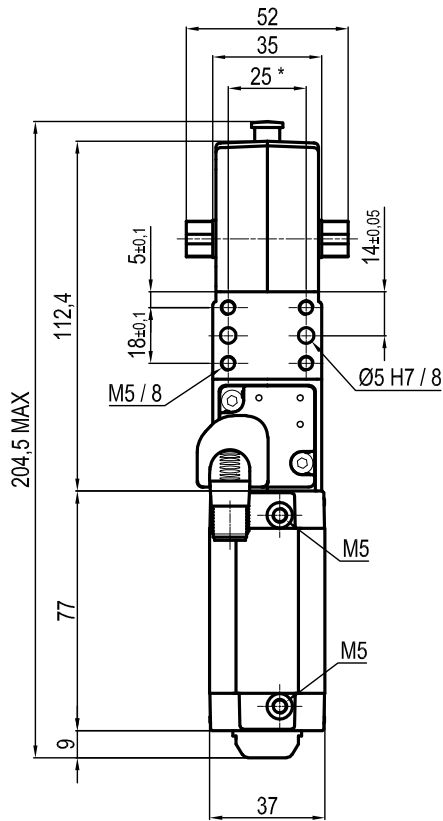

Bore Ø	Holding moment	Clamping moment (0,5 MPa)	Weight (clamping arm not included)
25 mm	75 Nm	25 Nm	0,8 Kg

Min./Max. operating pressure: **0,4 / 0,6 MPa**
 Operating temperature: **5° ÷ 45° C**
 Opening angle: **adjustable**
 Without arm
 Electronic sensor with M12 swivel connector, from 0° to 90°, in steps of 10°
 Supply voltage: 10 ÷ 30 Vdc
 IP code: **IP 65**

* : TOLERANCE BETWEEN DOWELS ± 0,02, BETWEEN SCREW HOLES ± 0,1
 **: AREA TO ACCESS ANGLE ADJUSTMENT

Subject to technical modifications without notice

UCBP25OB_K0

0 mm

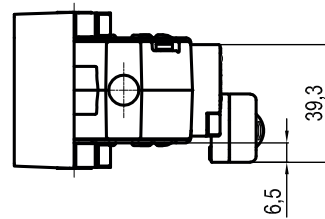
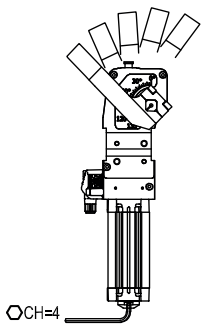
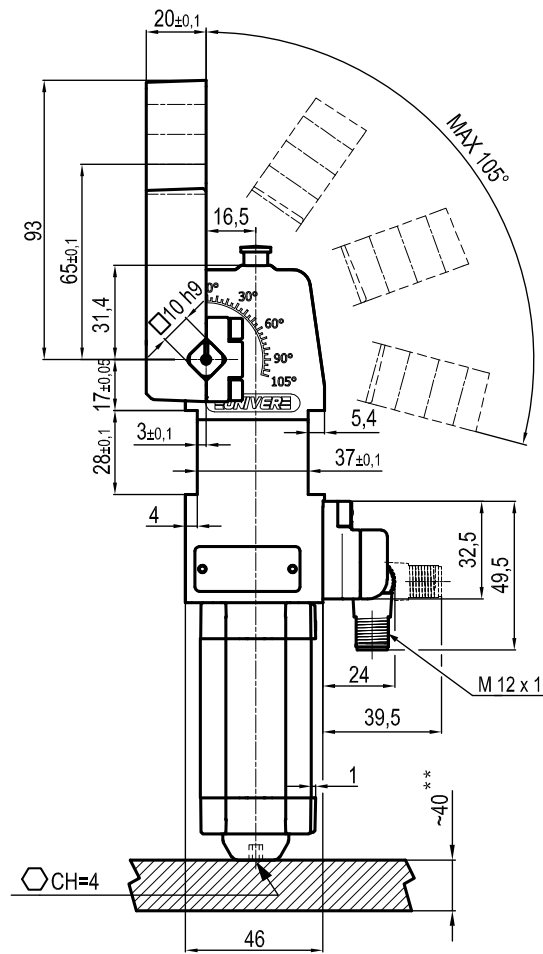
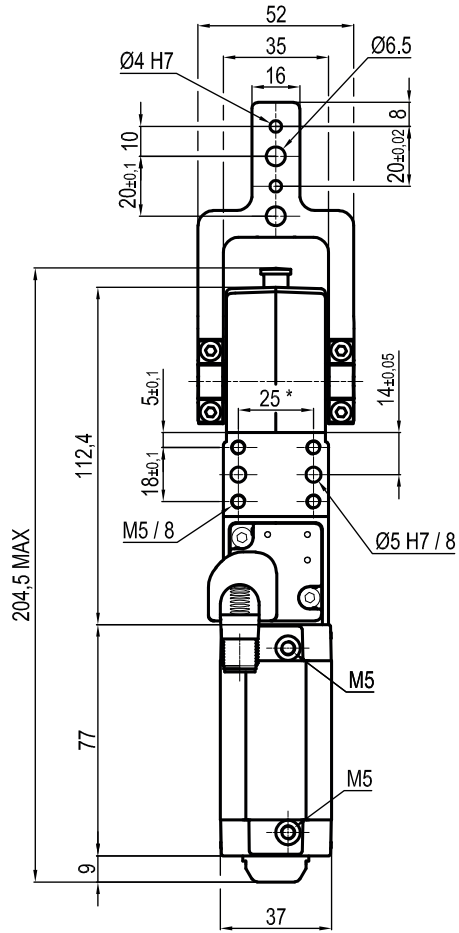

Bore Ø	Holding moment	Clamping moment (0,5 MPa)	Weight (clamping arm not included)
25 mm	75 Nm	25 Nm	0,8 Kg

 Min./Max. operating pressure: **0,4 / 0,6 MPa**

 Operating temperature: **5° ÷ 45° C**

 Opening angle: **adjustable from 0° to 105°**

 Arm position: **180°**

Electronic sensor with M12 swivel connector, from 0° to 90°, in steps of 10°

Supply voltage: 10 ÷ 30 Vdc

 IP code: **IP 65**

*: TOLERANCE BETWEEN DOWELS ± 0,02, BETWEEN SCREW HOLES ± 0,1

**: AREA TO ACCESS ANGLE ADJUSTMENT

Subject to technical modifications without notice

Rev. 01 23.09.20

UCBP25VB_K0

0 mm

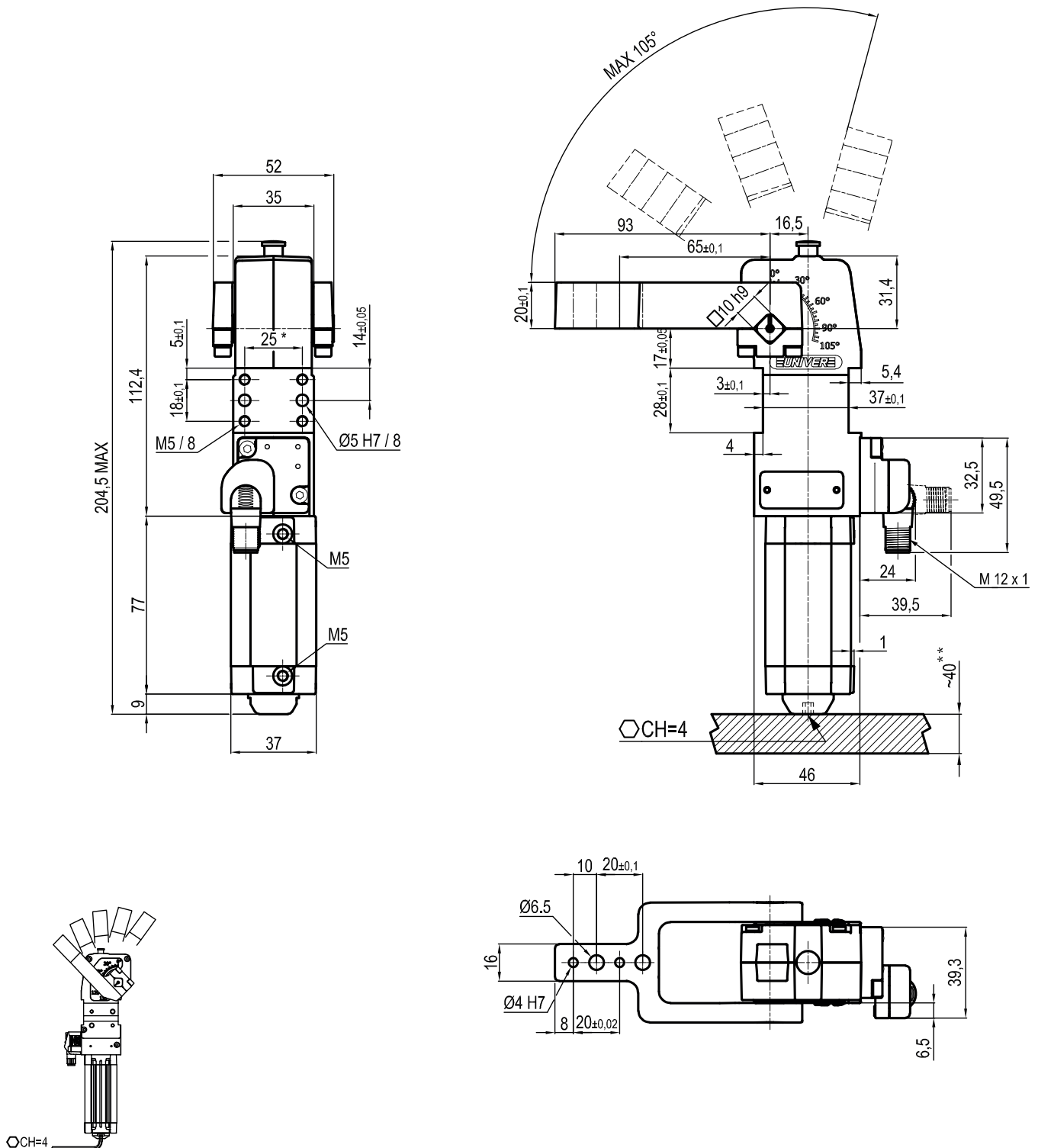

Bore Ø	Holding moment	Clamping moment (0,5 MPa)	Weight (clamping arm not included)
25 mm	75 Nm	25 Nm	0,8 Kg

 *: TOLERANCE BETWEEN DOWELS $\pm 0,02$, BETWEEN SCREW HOLES $\pm 0,1$

**: AREA TO ACCESS ANGLE ADJUSTMENT

 Min./Max. operating pressure: **0,4 / 0,6 MPa**

 Operating temperature: **5° ÷ 45° C**

 Opening angle: **adjustable from 0° to 105°**

 Arm position: **90°**

Electronic sensor with M12 swivel connector, from 0° to 90°, in steps of 10°

Supply voltage: 10 ÷ 30 Vdc

 IP code: **IP 65**

Subject to technical modifications without notice

UCBP25OC_K0

10 mm

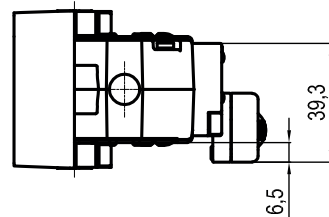
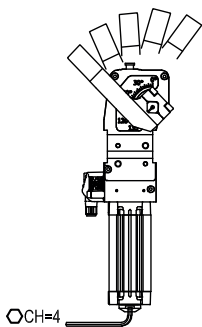
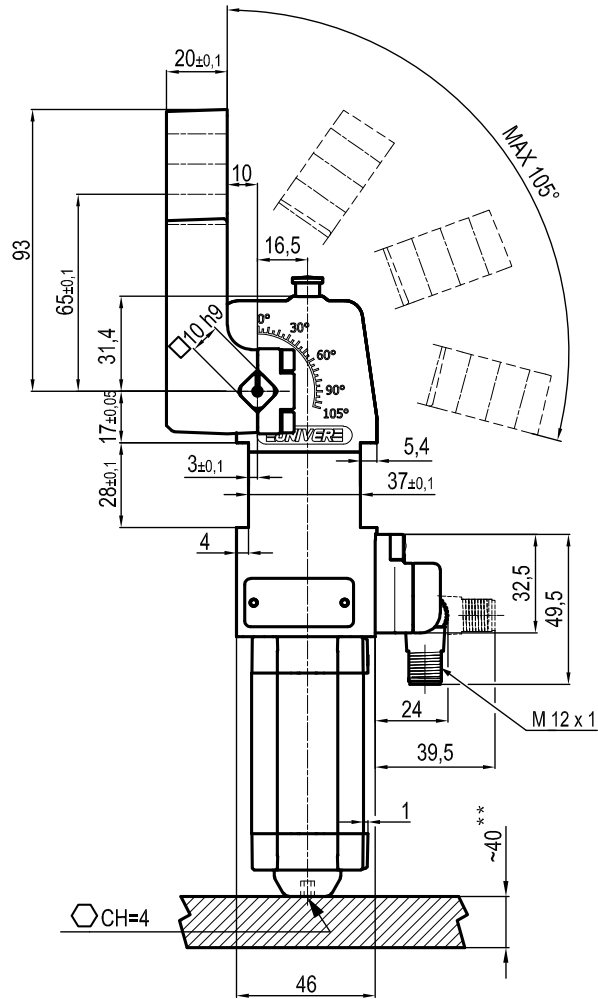
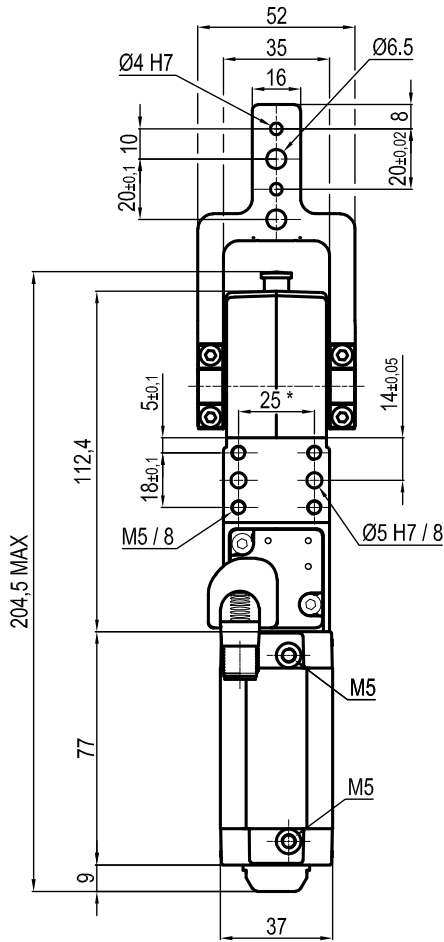

Bore Ø	Holding moment	Clamping moment (0,5 MPa)	Weight (clamping arm not included)
25 mm	75 Nm	25 Nm	0,8 Kg

*: TOLERANCE BETWEEN DOWELS ± 0,02, BETWEEN SCREW HOLES ± 0,1

**: AREA TO ACCESS ANGLE ADJUSTMENT

 Min./Max. operating pressure: **0,4 / 0,6 MPa**

 Operating temperature: **5° ÷ 45° C**

 Opening angle: **adjustable from 0° to 105°**

 Arm position: **180°**

Electronic sensor with M12 swivel connector, from 0° to 90°, in steps of 10°

Supply voltage: 10 ÷ 30 Vdc

 IP code: **IP 65**

Subject to technical modifications without notice

UCBP25VC_K0

10 mm

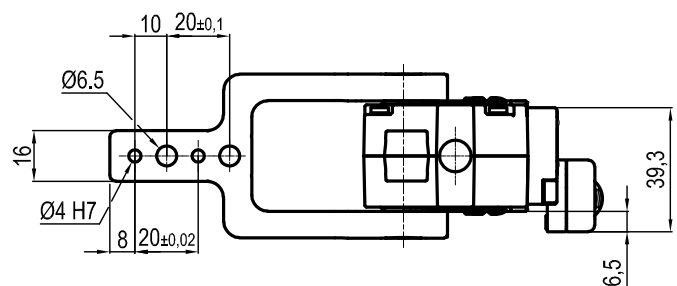
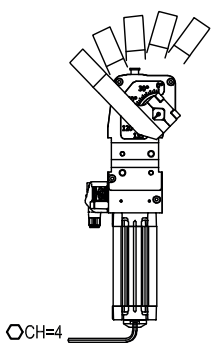
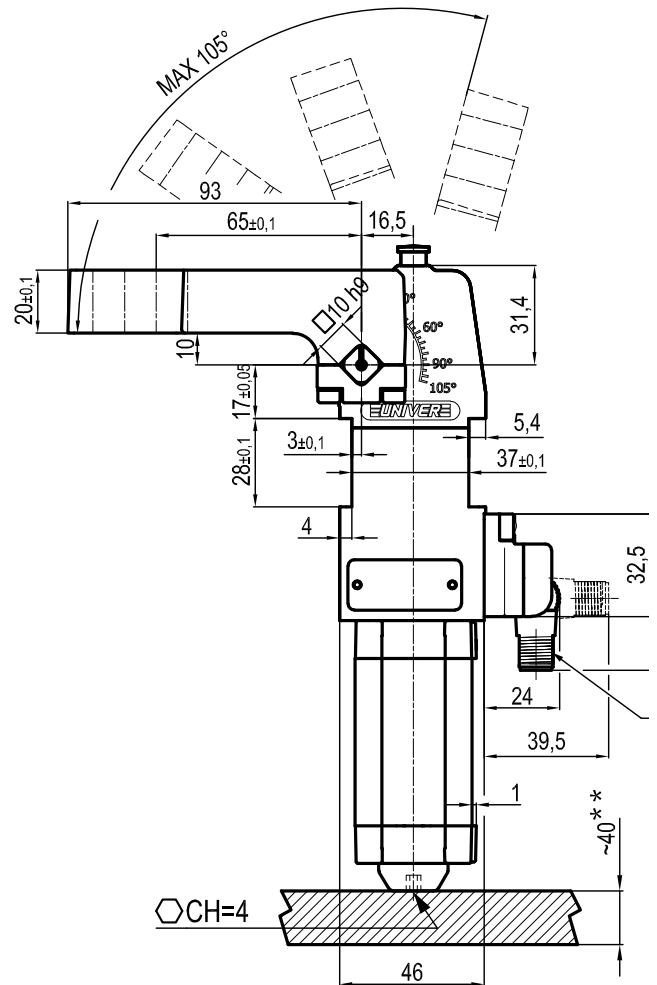
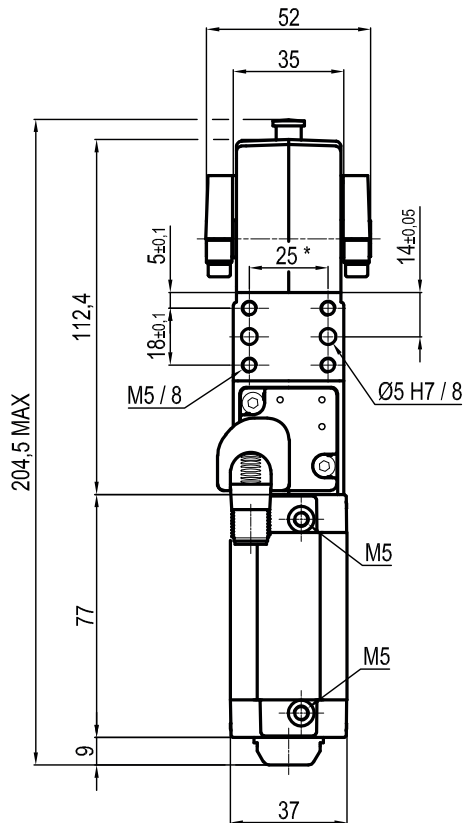

Bore Ø	Holding moment	Clamping moment (0,5 MPa)	Weight (clamping arm not included)
25 mm	75 Nm	25 Nm	0,8 Kg

 Min./Max. operating pressure: **0,4 / 0,6 MPa**

 Operating temperature: **5° ÷ 45° C**

 Opening angle: **adjustable from 0° to 105°**

 Arm position: **90°**

Electronic sensor with M12 swivel connector, from 0° to 90°, in steps of 10°

Supply voltage: 10 ÷ 30 Vdc

 IP code: **IP 65**

*: TOLERANCE BETWEEN DOWELS ± 0,02, BETWEEN SCREW HOLES ± 0,1

**: AREA TO ACCESS ANGLE ADJUSTMENT

Subject to technical modifications without notice