

# UCBL463

Unità di bloccaggio manuali UNICLAMP

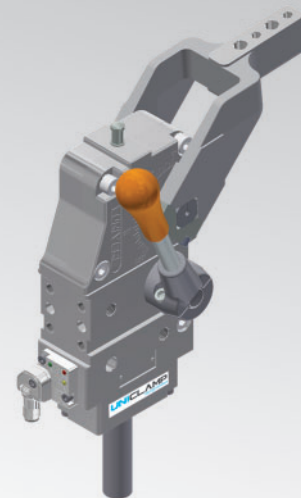

U	C	B	L	4	6	3	V	E	A	K	0
1	2	3	4	5	6	7	8	9	10		

1 Serie	2 Standard	3 Versione	4 Fissaggio
---------	------------	------------	-------------

**UC** = Unità di bloccaggio manuali UNICLAMP con regolazione continua angolo d'apertura da: **0° a 135° max**  
L'angolo di apertura può variare a seconda della posizione e della tipologia del pressore

**B** = Standard europeo

**L** = Unità di bloccaggio manuale con leva manuale

**4** = Sui 4 lati

5 Taglia	6 Posizione pressore	7 Tipo di pressore
----------	----------------------	--------------------

**63** = Ø 63

**V** = 90°

**O** = 180°

**N** = No arm

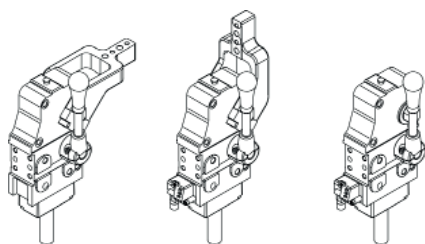

**C** = Centrale, 15 mm Offset

**D** = Destro, 15 mm Offset

**S** = Sinistro, 15 mm Offset

**E** = Centrale, 45mm Offset

**F** = Destro, 45mm Offset

**L** = Sinistro, 45mm Offset

**X\*** = Centrale, con fori maggiorati Ø 8 H7, 15 mm offset

**Y\*** = Destro, con fori maggiorati Ø 8 H7, 15 mm offset

**Z\*** = Sinistro, con fori maggiorati Ø 8 H7, 15 mm offset

**T\*** = Centrale, con fori maggiorati Ø 8 H7, 45 mm offset (solo per UCBL450)

**U\*** = Destro, con fori maggiorati Ø 8 H7, 45 mm offset (solo per UCBL450)

**V\*** = Sinistro, con fori maggiorati Ø 8 H7, 45 mm offset (solo per UCBL450)

**N** = Senza pressore

\* = Disponibile su richiesta

8 Materiale pressore	9 Sensore	10 Revisione prodotto
----------------------	-----------	-----------------------

**A** = Alluminio

**S** = Acciaio

**N** = Senza pressore

**N** = Senza sensore

(con piastra di chiusura)

**K** = Sensore elettronico PNP (ottico) (DF-K)

Assigned by UNIVER

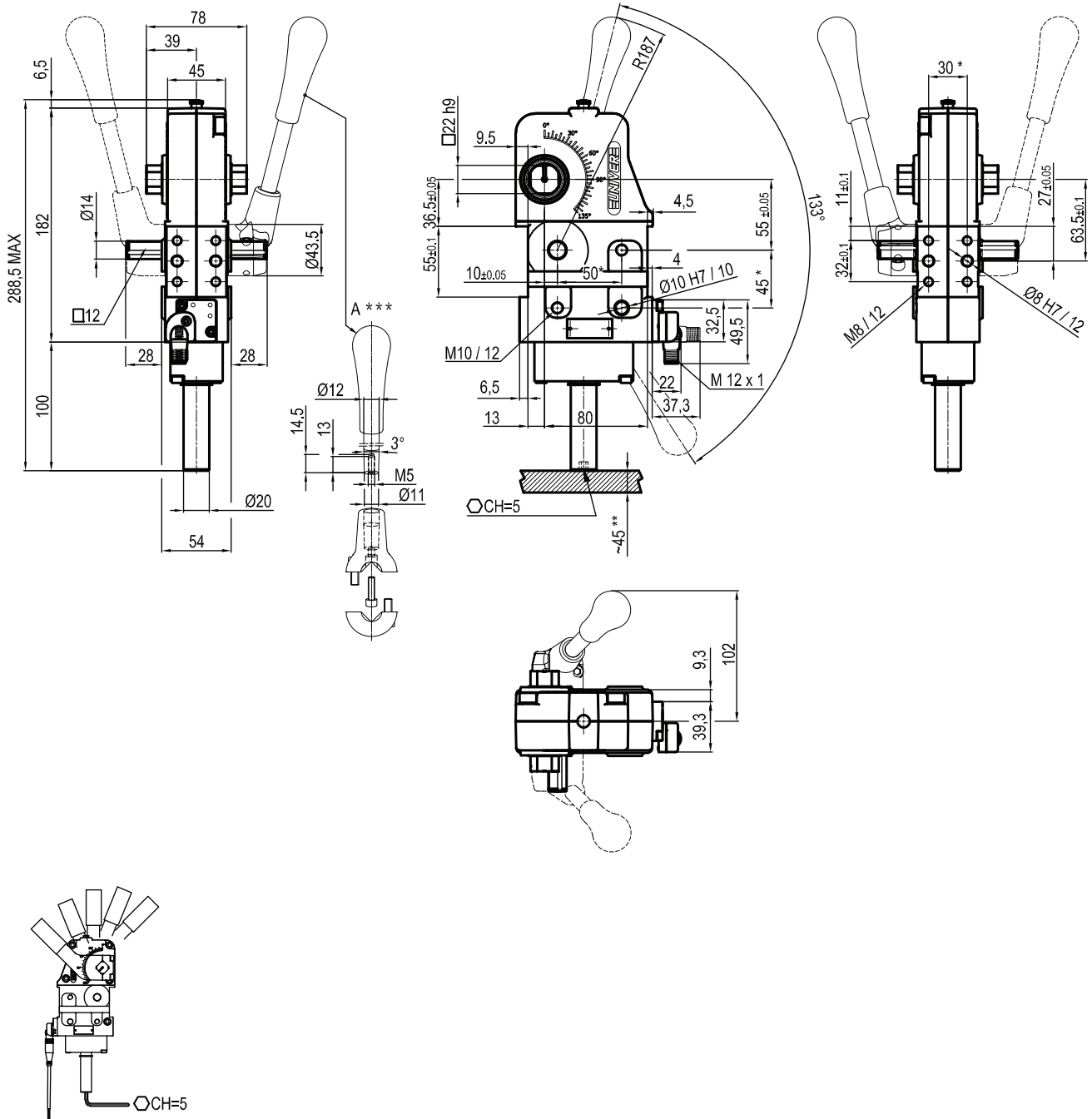
**UCBL463NNNK0**

Size	Holding moment	Clamping moment	Weight (clamping arm not included)
63	1750 Nm	420 Nm	2,95 Kg

\* : TOLERANCE BETWEEN DOWELS  $\pm 0,02$ , BETWEEN SCREW HOLES  $\pm 0,1$   
 \*\* : AREA TO ACCESS ANGLE ADJUSTMENT  
 \*\*\* : DIMENSIONS TO BE RESPECTED IN CASE OTHER MANUAL LEVERS ARE USED

Operating temperature:  $5^{\circ} \div 45^{\circ} \text{C}$   
 Opening angle: **adjustable**  
 Without arm  
 With hand lever  
 Electronic sensor with M12 swivel connector, from  $0^{\circ}$  to  $90^{\circ}$ , in steps of  $10^{\circ}$   
 Supply voltage:  $10 \div 30 \text{ Vdc}$   
 IP code: **IP 65**

Subject to technical modifications without notice

Rev. 00 19.09.19

## UCBL463O\_\_K0

## 15 mm

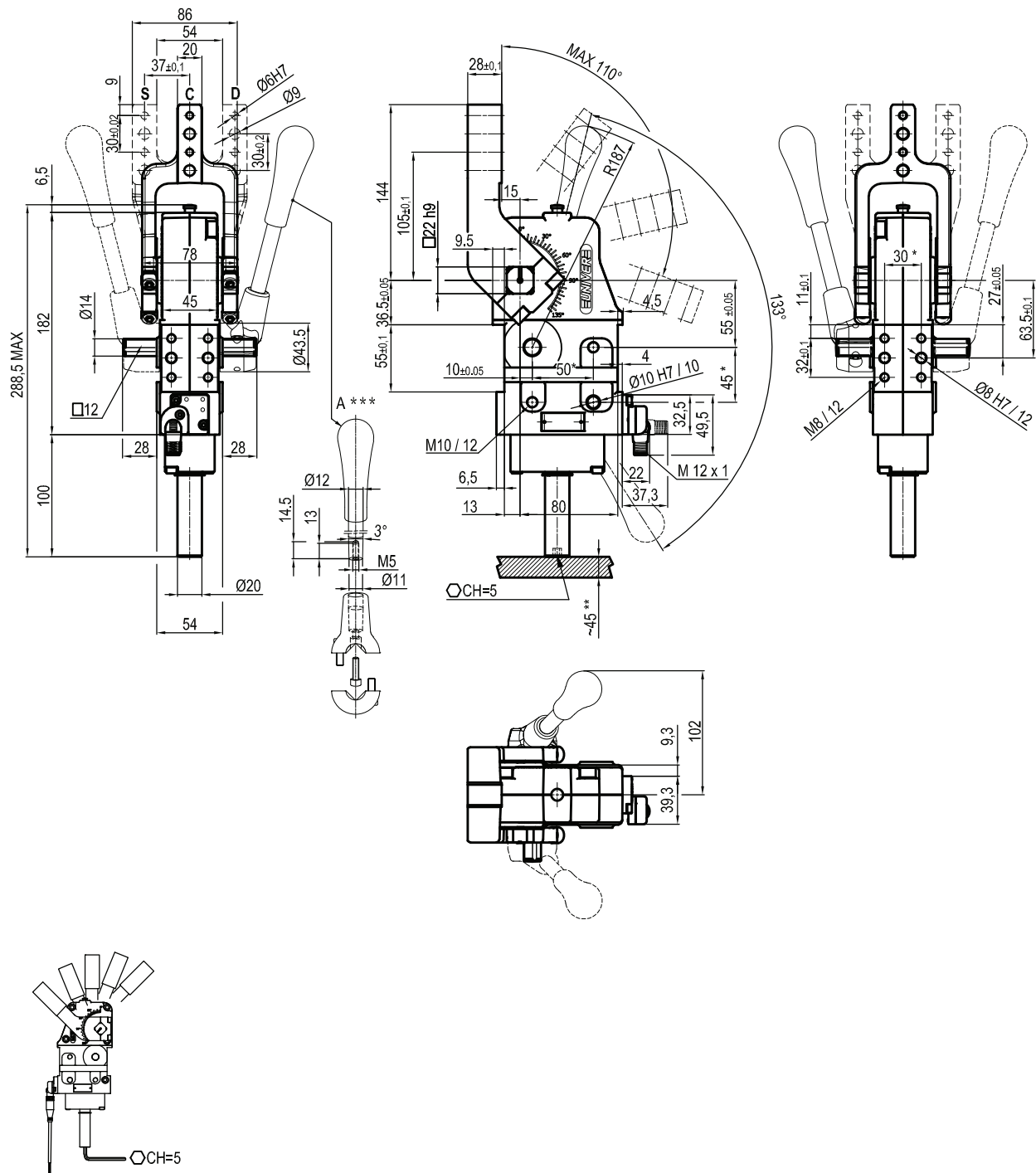

Size	Holding moment	Clamping moment	Weight (clamping arm not included)
63	1750 Nm	420 Nm	2,95 Kg

\* : TOLERANCE BETWEEN DOWELS  $\pm 0,02$ , BETWEEN SCREW HOLES  $\pm 0,1$

\*\* : AREA TO ACCESS ANGLE ADJUSTMENT

\*\*\* : DIMENSIONS TO BE RESPECTED IN CASE OTHER MANUAL LEVERS ARE USED

Operating temperature:  $5^{\circ} \pm 45^{\circ} \text{C}$

Opening angle: **adjustable from  $0^{\circ}$  to  $110^{\circ}$**

Arm position:  **$180^{\circ}$**

With manual lever

Electronic sensor with M12 swivel connector, from  $0^{\circ}$  to  $90^{\circ}$ , in steps of  $10^{\circ}$

Supply voltage:  $10 \div 30 \text{Vdc}$

IP code: **IP 65**

## UCBL463V\_\_K0

## 15 mm

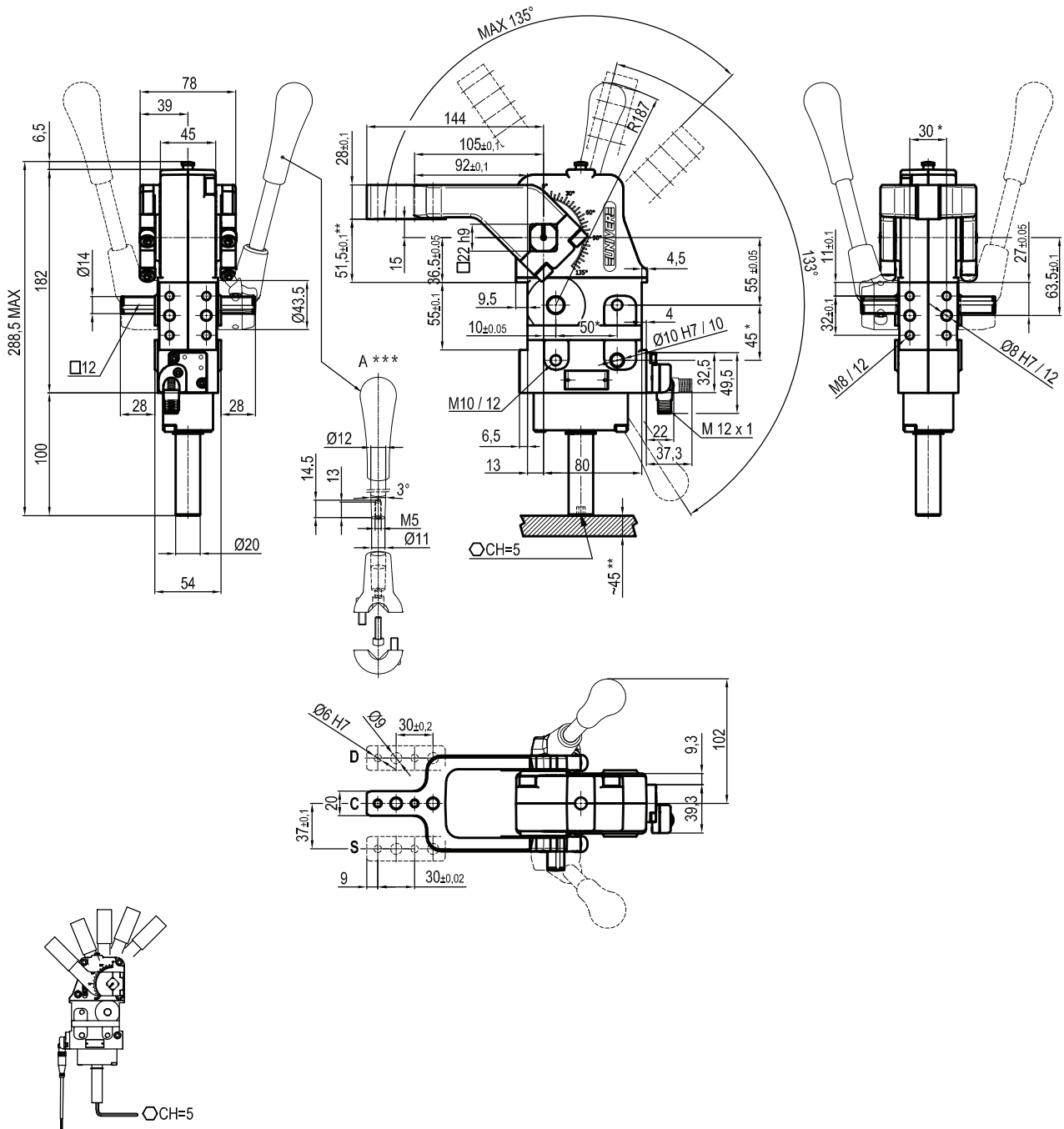

Size	Holding moment	Clamping moment	Weight (clamping arm not included)
63	1750 Nm	420 Nm	2,95 Kg

Operating temperature: 5°÷ 45° C  
 Opening angle: **adjustable from 0° to 135°**  
 Arm position: **90°**  
 With manual lever  
 Electronic sensor with M12 swivel connector, from 0° to 90°, in steps of 10°  
 Supply voltage: 10 ÷ 30 Vdc  
 IP code: **IP 65**

\*: TOLERANCE BETWEEN DOWELS ± 0,02, BETWEEN SCREW HOLES ± 0,1  
 \*\*: AREA TO ACCESS ANGLE ADJUSTMENT  
 \*\*\*: DIMENSIONS TO BE RESPECTED IN CASE OTHER MANUAL LEVERS ARE USED

Subject to technical modifications without notice

Rev. 00 19.09.19

## UCBL463O\_\_K0

## 45 mm

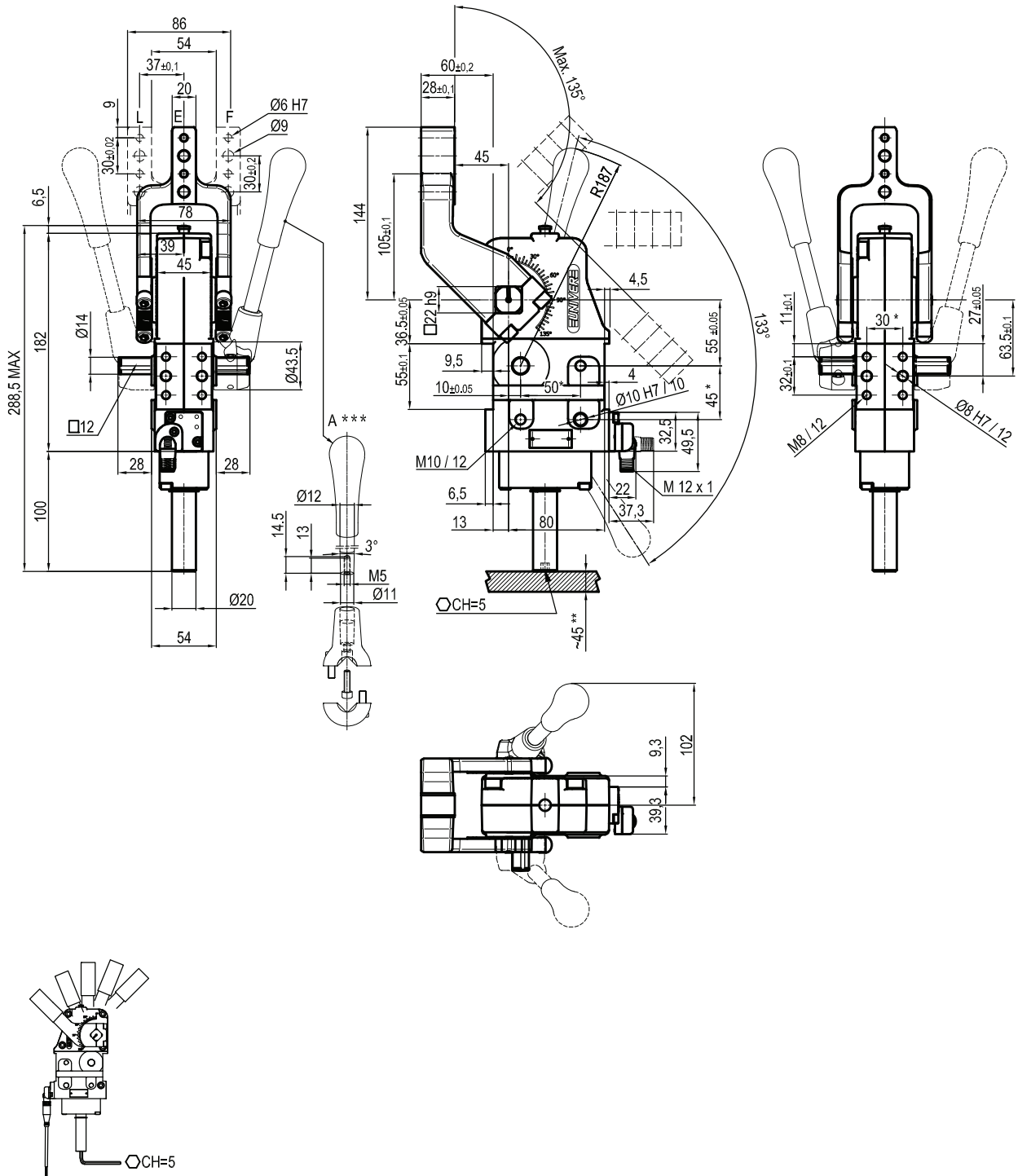

Size	Holding moment	Clamping moment	Weight (clamping arm not included)
63	1750 Nm	420 Nm	2,95 Kg

\* : TOLERANCE BETWEEN DOWELS  $\pm 0,02$ , BETWEEN SCREW HOLES  $\pm 0,1$

\*\* : AREA TO ACCESS ANGLE ADJUSTMENT

\*\*\*: DIMENSIONS TO BE RESPECTED IN CASE OTHER MANUAL LEVERS ARE USED

Operating temperature:  $5^{\circ} \div 45^{\circ} \text{C}$

Opening angle: **adjustable from  $0^{\circ}$  to  $135^{\circ}$**

Arm position:  **$180^{\circ}$**

With manual lever

Electronic sensor with M12 swivel connector, from  $0^{\circ}$  to  $90^{\circ}$ , in steps of  $10^{\circ}$

Supply voltage:  $10 \div 30 \text{ Vdc}$

IP code: **IP 65**

## UCBL463V\_\_K0

45 mm

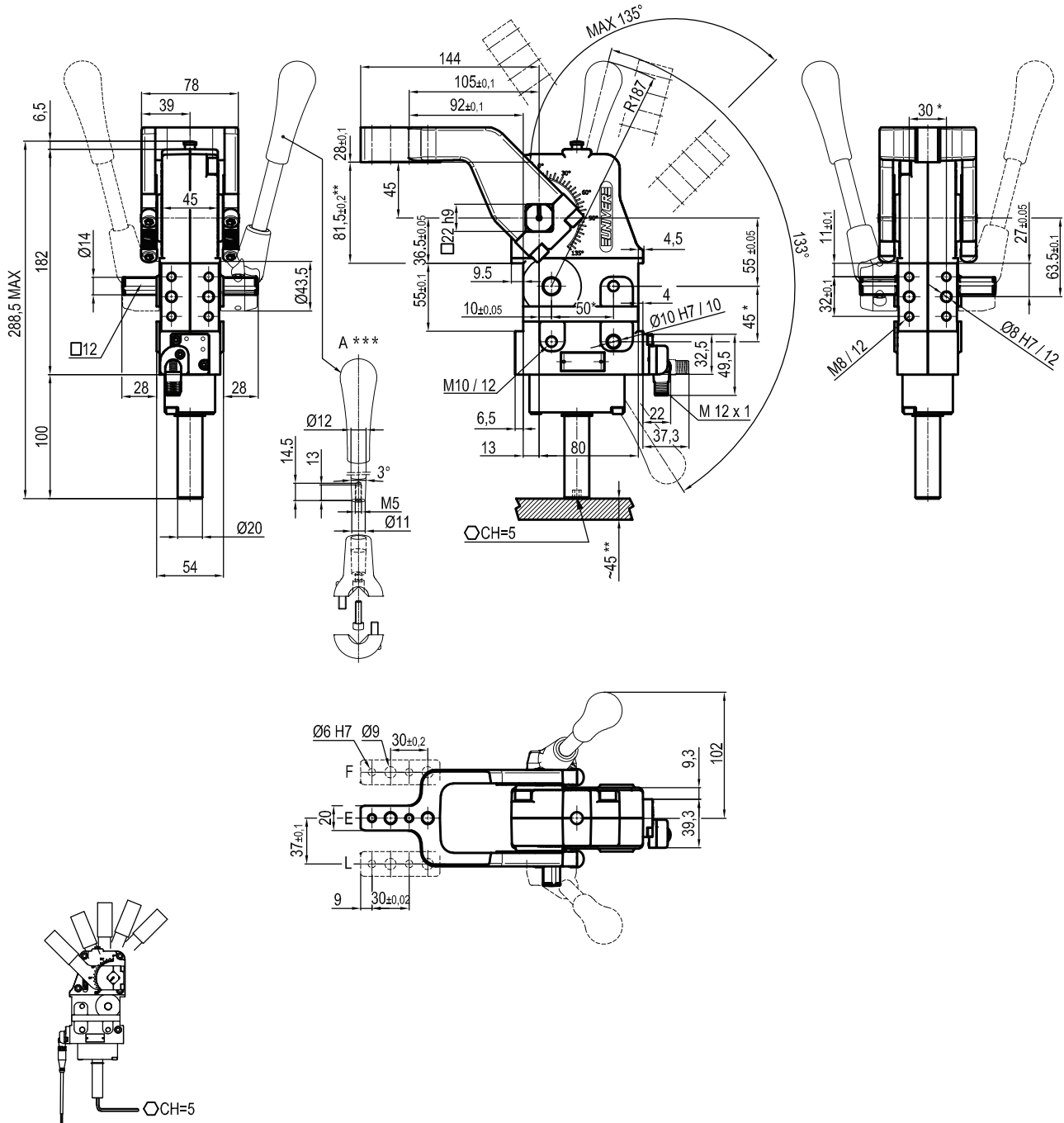

Size	Holding moment	Clamping moment	Weight (clamping arm not included)
63	1750 Nm	420 Nm	2,95 Kg

Operating temperature: 5°÷ 45° C  
 Opening angle: **adjustable from 0° to 135°**  
 Arm position: **90°**  
 With manual lever  
 Electronic sensor with M12 swivel connector, from 0° to 90°, in steps of 10°  
 Supply voltage: 10 ÷ 30 Vdc  
 IP code: **IP 65**

\*: TOLERANCE BETWEEN DOWELS ± 0,02, BETWEEN SCREW HOLES ± 0,1  
 \*\*: AREA TO ACCESS ANGLE ADJUSTMENT  
 \*\*\*: DIMENSIONS TO BE RESPECTED IN CASE OTHER MANUAL LEVERS ARE USED